

# SPRINT™ HOLDFAST

## ELECTRO-MAGNETIC DOOR HOLDERS DH SERIES

### ● SPECIFICATIONS AND TECHNICAL DETAILS

#### ● DIMENSIONS :

- DH501 80mmLx80mmWx40mmH
- DH502 100mmLx70mmWx40mmH
- DH503 80mmLx80mmWx40-240mmH (UPON REQUEST)
- DH504 118mmLx92mmWx120mmH
- DH505 120mmLx76mmWx28mmH

- CURRENT DRAW : 100mA / 12VDC, 50mA / 24VDC
- HOLDING FORCE : ABOUT 50 KGS.
- DUAL VOLTAGE : 12V / 24VDC
- ADJUSTABLE OR FIXED ARMATURE PLATE
- BUILT-IN SPIKE SUPPRESSOR

DH501

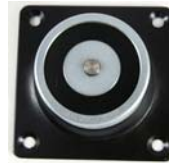

DH502



DH503



DH504

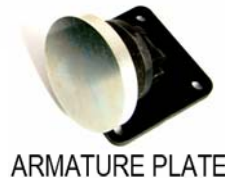

ARMATURE PLATE



DH505

### ■ INSTALLATION

#### AVAILABLE ARMATURE PLATE TYPES

ADJUSTABLE TYPE

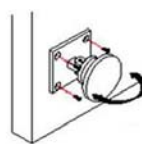

FIXED TYPE

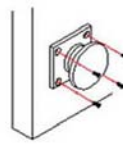

BUILT-IN TYPE

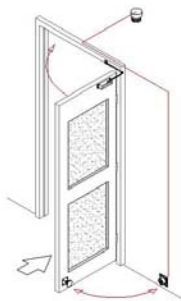
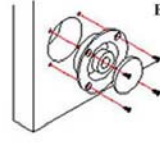

DH501  
BASIC WALL MOUNT

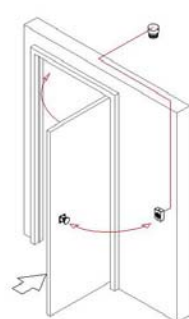

DH502  
WITH SWITCH WALL MOUNT

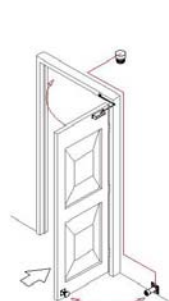

DH503  
EXTENDED WALL MOUNT

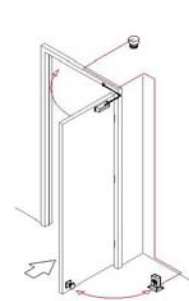

DH504  
WITH SWITCH FLOOR MOUNT

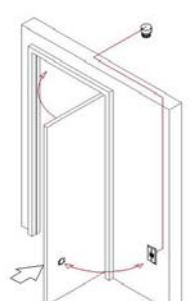

DH505  
WALL FLUSH MOUNT

SPRINT RESERVES THE RIGHT TO CHANGE SPECIFICATIONS WITHOUT NOTICE.



LISTED  
RELEASING DEVICES  
ST80